

RRFR

Filter holder return grille

Description

Extruded aluminum supply grille with moving horizontal slats that can be individually regulated to adapt the air range and the air stream to the needs of the zone. 26-mm standard frame. Provided with filters to prevent the return of airborne dust particles.

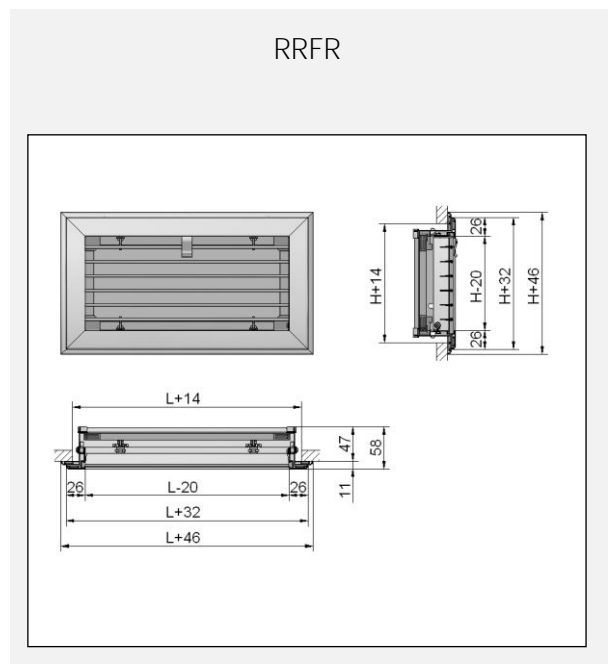

Technical specs

Sizes	Standard size: H: 100 - 400 mm → L: 200 - 800 mm H: 450 mm → L: 200 – 700 mm H: 500 mm → L: 200 – 650 mm H: 550 – 600 mm → L: 200 – 600 mm
Material	Extruded aluminum
Finish	White (RAL 9010) Anodized
Fixing*	Screw (T), mounting frame required
Compatible accessories	Antiparticle filter (FILT)

*Note: to mount grilles in the ceiling, Airzone recommends using fixing screws.

RRFR selection board

AK (dm ²)	LxH (mm)	QV (m ³ /h)										
		200	300	400	500	750	1000	1500	2000	3000	4000	5000
1,3	200x100	25,0 - 4,5 35,0										
2,0	300x100 200x150	16,0 - 2,8 15,0	27,0 - 4,2 35,0									
3,0	400x100 300x150 200x200	- - 1,9 7,0	19,0 - 2,9 16,0	26,0 - 3,7 27,0								
4,5	600x100 400x150 300x200		- - 1,9 7,0	18,0 - 2,5 12,0	23,0 - 3,1 20,0							
6,0	800x100 500x150 400x200				17,0 - 2,3 10,0	27,0 - 3,5 24,0						
7,5	600x150 500x200 300x300				- - 1,8 6,5	22,0 - 2,7 15,0	30,0 - 3,8 28,0					
9,3	800x150 600x200 400x300					18,0 - 2,2 10,0	25,0 - 3,0 18,0	35,0 - 4,5 40,0				
12,5	800x200 500x300 400x400					- - 1,6 5,0	19,0 - 2,2 10,0	29,0 - 3,4 22,0				
15,0	600x300						- - 1,8 7,0	25,0 - 2,7 15,0	32,0 - 3,7 26,0			
17,5	800x250 500x400						- - 1,6 5,0	21,0 - 2,4 11,0	29,0 - 3,2 20,0			
20,0	800x300 600x400 500x500							19,0 - 2,1 9,0	26,0 - 2,8 15,0	36,0 - 4,1 33,0		
26,0	800x400 600x500							- - 1,6 5,0	21,0 - 2,2 10,0	31,0 - 3,2 20,0	37,0 - 4,1 33,0	
35,0	600x600									28,0 - 2,8 14,0	35,0 - 3,7 26,0	

NR	Lt	Sound level in dB	Range in meters
V	Pa	Speed in m/s	Pressure in pascals

AK: Effective area (dm ²)	L: Length (mm)
QV: Flow (m ³ /h)	H: Height (mm)

Results obtained using software simulation

Tightening and installing the grille

This grille does not require a mounting frame. First, you should open the grille so that you can proceed to use the drill to attach the grille to the wall or to the ceiling.

1. Grab the handle, twist it as shown below in the pictures and pull it.
2. Fold the grille.

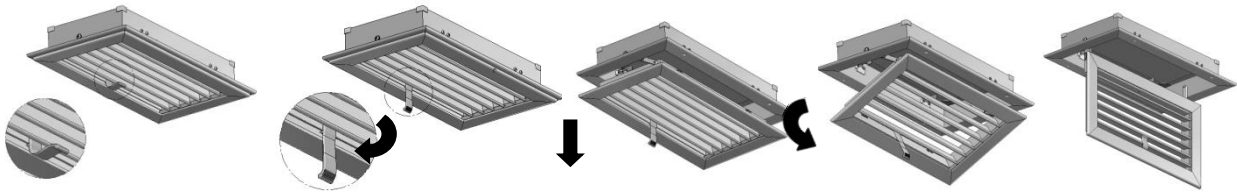

Once open, follow these instructions to mount it (wall mounting or ceiling mounting):

1. Screw the grille. Make sure the grille is well-secured (you will be required to extract the filter for maintenance purposes).
2. Turn the grille and push to close it.

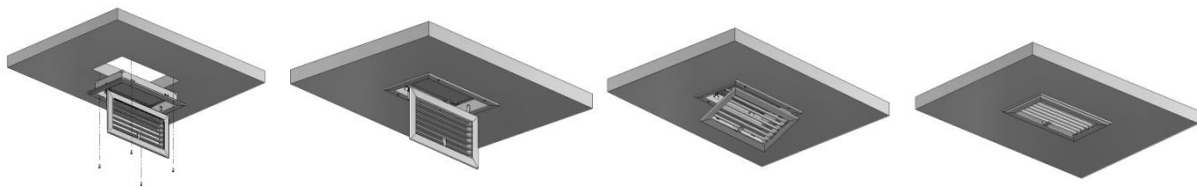

Maintenance – Filter cleaning

This filter requires regular maintenance. It is composed by a filter pad and two metal meshes at each side, all framed by aluminum profile.

To clean it, extract the filter as follows:

1. Switch the bolts (4) that hold the filter.
2. Grab the filter and extract it.

